

Callaghans

Independent Estate Agents, Surveyors, Valuers and Mortgage Brokers

11 Cartmel Close, Gatley SK8 4QP



£265,000

No Chain

Renovation Required

Off Road Parking

Extended Single Garage

Private Rear Garden

Cul-De-Sac Location

Callaghans Estate Agents

46 Church Road, Gatley, SK8 4NQ

Telephone: 0161 491 4000, Fax: 0161 491 55 44

Website: www.callaghansltd.com Email: admin@callaghansltd.com

This three bedroom detached bungalow is set in an elevated position, on a quiet cul-de-sac on the popular Lakes Estate. All rooms are of decent proportions and in need of modernisation. There are two private driveways, single garage and private rear garden. The Lakes Estate is a peaceful, safe location and well-placed for access to the amenities of Gatley and Cheadle. Transport links are within proximity for the convenience of travel.

Living Room 13' 7" x 11' 5" (4.14m x 3.48m) The large living room has two floor to ceiling windows and is open plan to the dining area.

Dining Room 8' 8" x 8' 4" (2.64m x 2.54m) A spacious dining area leading through to the kitchen.

Kitchen 10' 4" x 8' 6" (3.15m x 2.59m) The kitchen is in need of modernisation and provides access to the side yard and rear garden.

Bedroom One 11' 6" x 10' 4" (3.50m x 3.15m) The main bedroom is of a generous size, to the rear aspect of the property with views overlooking the garden.

Bedroom Two 10' 10" x 10' 2" (3.30m x 3.10m) To the rear aspect of the property overlooking the garden, the second bedroom is double in size.

Bedroom Three 8' 6" x 6' 11" (2.59m x 2.11m) The third bedroom is single in size and lends itself for usage as a bedroom, hobby room or dressing room.

Bathroom 7' 8" x 6' 3" (2.34m x 1.90m) The bathroom is in need of modernisation, currently consisting of bath with shower overhead, sink and toilet.

External There are two driveways to the side of the property, an extended single garage, gated side yard and rear garden fenced and hedged for privacy including an array of shrubs and mature trees.

GROUND FLOOR
769 sq.ft. (71.5 sq.m.) approx.

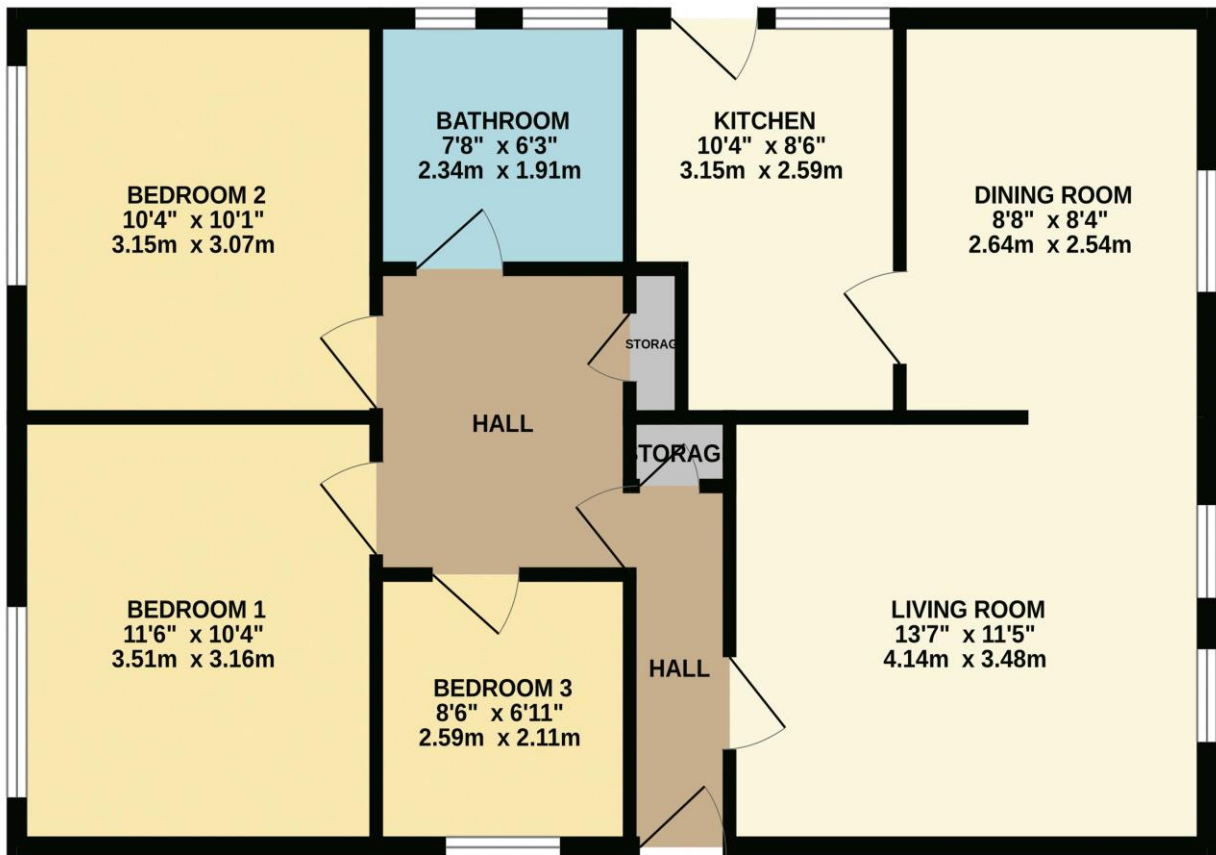

Disclaimer:

These particulars, whilst believed to be accurate are set out as a general guideline only or guidance and do not constitute any part of an offer or contract. Intending purchasers should not rely on them as statements of representation or fact, but must satisfy themselves by inspection or otherwise as to their accuracy. Please note that we have not tested any apparatus, equipment, fixtures, fittings or services, including gas central heating and so cannot verify they are in working order or fit for their purpose. Further more solicitors should confirm movable items described in the sales particulars are, in fact included in the sale since circumstances do change during marketing or negotiations. Although we try to ensure accuracy, measurements used in this brochure may be approximate. Therefore if intending purchasers need accurate measurements to order carpeting or to ensure existing furniture will fit, they should take such measurements themselves. **YOUR HOME IS AT RISK IF YOU DO NOT KEEP UP REPAYMENTS ON A MORTGAGE OR OTHER LOAN SECURED ON IT**